

Pignons pour chaines 820-831

Pignons Uni :

Nb de dents	Ø primitif		Ø extérieur		alésage mini		alésage maxi		Ø du moyeu		Dimension A		Dimension B		moulé PA6 LG		moulé en fonte		usiné	
	mm	in	mm	in	mm	in	mm	in	mm	in	mm	in	mm	in	mm	in	mm	in	mm	in
Z19	117.3	4.62	117.0	4.61	20.0	0.79	40.0	1.57	58.0	2.28	58.7	2.31	65.9	2.59	✓	✓				
Z21	129.2	5.09	130.0	5.12	20.0	0.79	40.0	1.57	58.0	2.28	65.0	2.56	71.8	2.83	✓	✓				
Z23	141.2	5.56	142.0	5.59	20.0	0.79	40.0	1.57	58.0	2.28	71.2	2.80	77.8	3.06	✓	✓				
Z25	153.2	6.03	155.0	6.10	20.0	0.79	40.0	1.57	58.0	2.28	77.4	3.05	83.8	3.30	✓	✓				
Z27	165.2	6.50	167.0	6.57	20.0	0.79	70.0	2.76	-	-	83.6	3.29	89.8	3.54		✓	✓		✓	
Z29	177.2	6.98	179.0	7.05	20.0	0.79	70.0	2.76	-	-	89.8	3.54	95.8	3.77		✓	✓		✓	
Z31	189.3	7.45	192.0	7.56	20.0	0.79	70.0	2.76	-	-	95.9	3.78	101.8	4.01		✓	✓		✓	

moulé en 2 parties

Nb de dents	Ø primitif		Ø extérieur		alésage mini		alésage maxi		Ø du moyeu		Dimension A		Dimension B		moulé PA6 LG	
	mm	in	mm	in	mm	in	mm	in	mm	in	mm	in	mm	in	mm	in
Z19	117.3	4.62	117.0	4.31	20.0	0.79	40.0	1.57	58.0	2.28	58.7	2.31	65.9	2.59		✓
Z21	129.2	5.09	130.0	4.81	20.0	0.79	40.0	1.57	58.0	2.28	65.0	2.56	71.8	2.83		✓
Z23	141.2	5.56	142.0	5.30	20.0	0.79	40.0	1.57	58.0	2.28	71.2	2.80	77.8	3.06		✓
Z25	153.2	6.03	155.0	5.79	20.0	0.79	40.0	1.57	58.0	2.28	77.4	3.05	83.8	3.30		✓

moulé en PA6

moulé en fonte

usiné

moulé en 2 parties

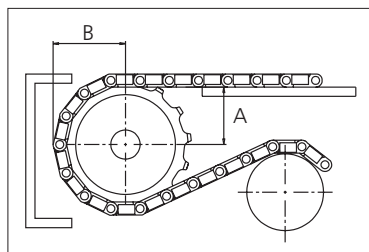

largeur du pignon = largeur de la denture = 42,3 mm