

Plastic Modular Belt

Series **uni JCB** Type **Y-Top**

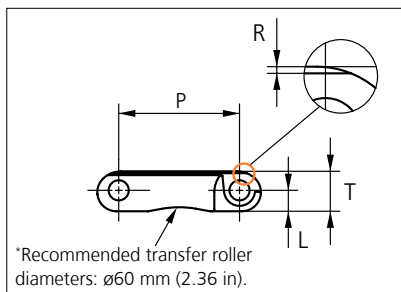
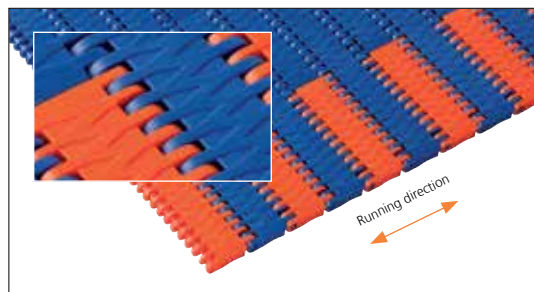

Straight running belt
 Nominal pitch: 25.4 mm (1.00 in)
 Surface type: Y Pattern surface grid
 Surface opening: 0%
 Backflex radius: 25.0 mm (0.98 in)
 Pin diameter: 4.0 mm (0.16 in)

Belt material & color	POM SLF B
Pin material & color	PA6.6 B PA6.6 B *

	mm	in		mm	in
P (Nominal)	25.4	1.00	T	8.4	0.33
L	4.4	0.17	R	0.4	0.02

POM SLF orange or yellow links can be used as SAFE WALK markers.
 *Only for K200 / K300 chain

Belt width		Permissible tensile force (Belt/pin material)		Belt weight (Belt/pin material)		*Min No drive sprocket per shaft	Number of wear strips (min no)	
		POM SLF/PA6.6		POM SLF/PA6.6			***Carry (pcs)	**Return (pcs)
mm	in	N	lbf	kg/m	lb/ft			
50.3 (chain)	2.0	1761	396	0.3	0.22	2	2	2
76 (chain)	3.0	2660	598	0.5	0.33	2	2	2
153	6.0	5355	1204	1.0	0.67	2	2	2
229	9.0	8015	1802	1.5	1.00	2	2	2
305	12.0	10675	2400	2.0	1.33	3	3	2
382	15.0	13370	3006	2.5	1.67	3	3	2
458	18.0	16030	3604	3.0	2.00	4	4	2
534	21.0	18690	4202	3.5	2.33	4	4	2
610	24.0	21350	4799	4.0	2.66	5	5	3
687	27.0	24045	5405	4.5	3.00	5	5	3
763	30.0	26705	6003	5.0	3.33	6	6	3
839	33.0	29365	6601	5.5	3.67	6	6	3
915	36.0	32025	7199	5.9	4.00	7	7	4

Standard Increments in belt width: 76.3 mm (3.00 in).

1983	78.1	69405	15602	12.9	8.66	14	14	7
------	------	-------	-------	------	------	----	----	---

Standard Increments in belt width: 76.3 mm (3.00 in).

2974	117.1	104090	23399	19.3	12.99	20	20	10
------	-------	--------	-------	------	-------	----	----	----

General belt tolerance is +0/-0.4% at 23°C/73°F and 50% RH. For exact belt width contact Customer Service. Non standard belt width on request.

*Max. Load per Drive Sprocket. Belt material: POM-SLF 2300 N (517 lbf).

**Max. Spacing between wear strips, Carry: 152 mm (6 in); Return: 304 mm (12 in).

***Full Carry way Support (FS) deck of wearstrip material recommended for safe walk belts.

= Single Link



Sprocket

No. of teeth	Bore size										Overall diameter		Pitch diameter		Hub diameter		Dimension A		Dimension B		Single row/Two way	Moulded	PA6 LG
	Pilot bore	1.00				1.18		1.25		1.50													
	mm	38.1	40.0	60.0	63.5	mm	in	mm	in	mm	in	mm	in	mm	in	mm	in	mm	in				
Z10	✓	●	●	●	■	●			80.3	3.16	82.2	3.24	65.0	2.56	34.7	1.36	45.5	1.79	✓	✓			
Z12	✓	●	●	●	■	●			96.8	3.81	98.1	3.86	70.0	2.76	43.0	1.69	53.5	2.11	✓	✓			
Z15	✓		●	●	■	●	■	1	121.5	4.78	122.2	4.81	¹ 70.0 ² 100.0 ² 104.0	2.76 13.94 4.09	55.4	2.18	65.5	2.58	✓	✓			
Z18	✓		●	●	■	●	■	2	146.0	5.75	146.3	5.76	¹ 70.0 ¹ 120.0 ² 104.0 ² 120.0	2.76 4.09 4.72	67.6	2.66	77.5	3.05	✓	✓			
Z19	✓		●	●	■	●	■	1	154.2	6.07	154.3	6.07	¹ 70.0 ¹ 120.0 ² 104.0 ² 120.0	2.76 4.72	71.7	2.82	81.6	3.21	✓	✓			

● Moulded sprocket ■ Moulded sprocket ■ Moulded sprocket

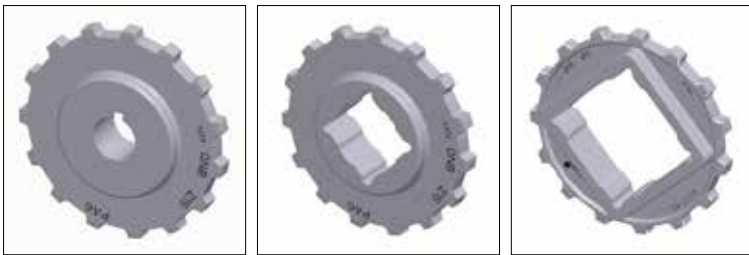

Other sprocket sizes are available upon request.
Round bores are always delivered with keyway.
Max load per sprocket shown does not take bore size into account.
Please also ensure that sufficient size shaft is chosen for corresponding load.
Other bore sizes are available upon request.
uni Retainer Rings: See uni Retainer Ring data sheet.
Width of tooth = 10.0 mm (0.39 in)
Width of OnePart sprocket = 25.0 mm (0.98 in)

uni UltraFit Two-Part Sprocket

No. of teeth	Bore size					Overall diameter		Pitch diameter		Hub/adaptor diameter		Hub/adaptor width		Dimension A		Dimension B		Single row/Two way	Moulded	PA6 LG	Adaptor Moulded	POM-D B
	in	1.50	1.57	2.36	2.50																	
	mm	38.1	40.0	60.0	63.5	mm	in	mm	in	mm	in	mm	in	mm	in	mm	in					
Z12		■	■			96.8	3.81	98.2	3.87	83.0	3.27	25.0 76.0	0.98 2.99	43	1.69	53.5	2.11	✓	✓	✓		
Z13		■	■			104.8	4.13	106.2	4.18	83.0	3.27	25.0 76.0	0.98 2.99	47.1	1.86	57.1	2.25	✓	✓	✓		
Z15		■	■	■	■	121.5	4.78	122.5	4.82	106.0	4.14	25.0 76.0	0.98 2.99	55.4	2.18	65.5	2.58	✓	✓	✓		
Z16		■	■	■	■	129.7	5.11	130.2	5.13	106.0	4.14	25.0 76.0	0.98 2.99	59.5	2.35	69.5	2.74	✓	✓	✓		
Z18		■	■	■	■	146.1	5.75	146.3	5.76	106.0	4.14	25.0 76.0	0.98 2.99	67.6	2.66	77.5	3.05	✓	✓	✓		
Z19		■	■	■	■	154.2	6.07	154.3	6.07	106.0	4.14	25.0 76.0	0.98 2.99	71.7	2.82	81.6	3.21	✓	✓	✓		

■ Moulded uni UltraFit TwoPart Sprocket (Narrow adaptor)
■ Moulded uni UltraFit TwoPart Sprocket (Wide adaptor)

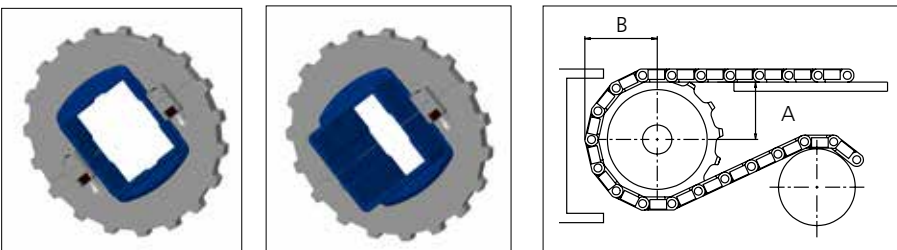

For correct sprocket position:
See uni Assembly Instructions for uni QNB.
For more detailed sprocket information contact Customer Service.